

April 17, 2015

**Fetzer Center
Western Michigan University**

Sponsored by:

Diether H. Haenicke Institute for Global Education
with

Timothy Light Center for Chinese Studies | Soga Japan Center | Confucius Institute at WMU
East Asian Forum

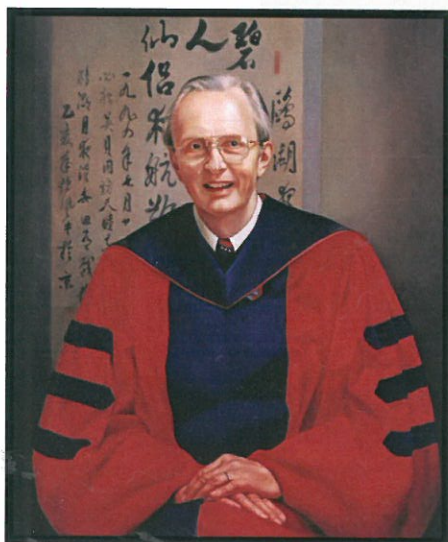

Dr. Timothy Light

Keynote Speaker

Dr. Timothy Light is Professor Emeritus of Comparative Religion/Asian and Middle Eastern Language and former Provost of WMU. He joined the WMU faculty in 1991. Dr. Light's academic career began at the Chinese University of Hong Kong, where he held several teaching and administrative positions from 1960 to 1971. He was a faculty member at the University of Arizona between 1974 and 1980. Dr. Light served as a professor and chairperson of the Department of East Asian Languages and Literature at Ohio State University from 1980 to 1986. He was named Provost and Professor of Linguistics and Asian Studies at Kalamazoo College in 1986 and served four years. In 1991, he accepted a position for one year as President of Middlebury College before coming to WMU. Dr. Light is the author of many scholarly books and articles for professional journals and has served as President of the Chinese Language Teachers Association and Vice President of the International Society for Chinese Language Teaching. Dr. Light holds a B.A. from Yale, B.D. Union Theological Seminary, M.A. from Columbia, and Ph.D. from Cornell University.

Conference Committee

Dr. Wolfgang Schlör, Haenicke Institute for Global Education, WMU

Dr. Ying Zeng, Haenicke Institute for Global Education, WMU

Dr. Wei-chiao Huang, Department of Economics, WMU

Dr. Takashi Yoshida, Department of History, WMU

The **Haenicke Institute for Global Education** supports the global engagement of Western Michigan University. Institute staff work closely with the International Education Council of the WMU Faculty Senate, as well as with international education committees and projects within and across colleges. The institute includes an intensive English program—CELCIS, international admissions and immigration services, study abroad services, Fulbright and national scholarship advising and support, and offers regular programming on campus and throughout the community. Additionally, the institute is home to four research centers and institutes: Center for African Policy Development Research; Confucius Institute at WMU; Soga Japan Center; and, the Timothy Light Center for Chinese Studies.

The **Timothy Light Center for Chinese Studies** serves as a focal point to enhance scholarship in Chinese studies at WMU and to disseminate China-related knowledge and understanding to the public. The Center was founded by private donations in honor of Dr. Timothy Light, an internationally renowned Sinologist, to recognize his lifetime achievements and commitment to advancing Chinese studies.

WMU Soga Japan Center, established in 2006, commits itself to promote knowledge of Japan to WMU and the community. The Center is named after the late Dr. Michitoshi Soga, WMU professor emeritus of physics, who worked tirelessly for nearly three decades to build a network of connections between WMU and Japan. The Center regularly brings scholars, artists, and writers to campus to give Japan-related lectures, demonstrations and readings to students, faculty, and the surrounding community.

The **Confucius Institute at WMU** was established at WMU in 2009 in partnership with Beijing Language and Culture University and the Chinese Language Council International (Hanban). It provides Chinese language and cultural studies opportunities for regional K-12 schools, local business, and the community, and supports the Chinese language program at WMU.

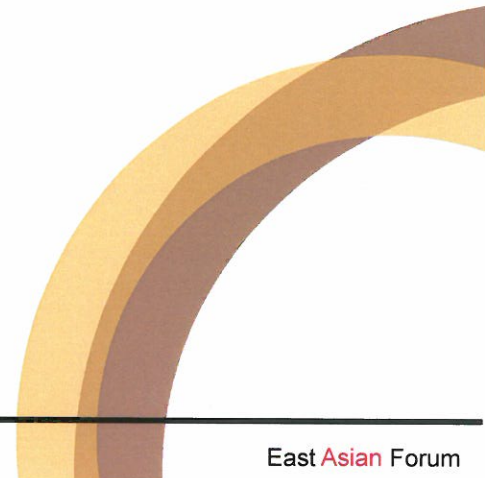

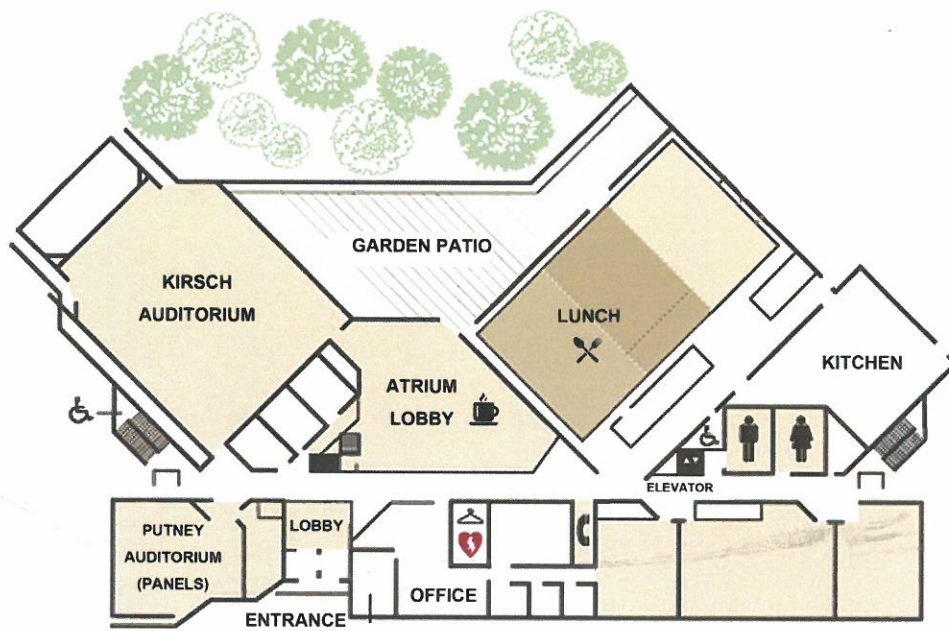

Fetzer Center Floor Plan



WESTERN MICHIGAN UNIVERSITY
Diether H. Haenicke
 Institute for Global Education

Western Michigan University
 1903 W Michigan Ave
 Kalamazoo MI 49008-5245 USA

+1(269) 387-5890 | wmu-international@wmich.edu | www.wmich.edu/international

PROGRAM

8:30—9:00 a.m.

Registration & Continental Breakfast 

9:00 – 9:15 a.m.

Welcoming Remarks

Dr. Wolfgang Schlör

9:15 – 10:30 a.m.

Panel I: Environment and Tourism in China

Li Yang, Associate Professor, Department of Geography, WMU

Lei Meng, Assistant Professor, Department of Geography, WMU

Chansheng He, Professor, Department of Geography, WMU

Gregory Veeck, and Charles Emerson, Professors, Department of Geography, WMU

10:30 – 10:45 a.m.

Coffee Break 

10:45 – 12 p.m.

Panel II: Language and Literature

Yue Hong, Assistant Professor, East Asian Studies, Kalamazoo College

Noriko Akimoto Sugimori, Assistant Professor, East Asian Studies, Kalamazoo College

Xin Yang, Graduate Student, Department of World Language and Literature, WMU

Xiaomeng Bu, Instructor, Department of World Languages and Literatures, WMU

Ruyuan Yang, Instructor, Department of World Languages and Literatures, and Confucius Institute, WMU

Noon – 1:15

Keynote Address and Lunch 

President John Dunn and Dr. Timothy Light

1:15 – 2:30 p.m.

Panel III: History, Literature and Religion of Japan

Takashi Yoshida, Associate Professor, Department of History, WMU

Carlos Pimentel, Assistant Professor, Department of World Languages and Literature, WMU

Eric Mendes, Graduate Student, Department of Comparative Religion, WMU

Stephen Covell, Professor and Chair, Department of Comparative Religion, WMU

Diane Riggs, Faculty Specialist, Department of Comparative Religion, WMU

2:30 – 2:45 p.m.

Coffee Break



2:45 – 4 p.m.

Panel IV: Asia and Globalization

Yuan-kang Wang, *Associate Professor, Department of Sociology, WMU*

Alexander M. Cannon, *Assistant Professor, School of Music, WMU*

Andrew Targowski, *Professor, Department of Business Information Systems, WMU*

4 – 4:15 p.m.

Coffee Break



4:15 – 5:30 p.m.

Panel V: Business and Finance

Wenling Lu, *Assistant Professor, Department of Finance and Commercial Law, WMU*

Hongli Zhang, *Visiting Scholar (associate professor, Jilin University)*

Ann Veeck, *Professor, Department of Marketing, WMU*

Christina Stamper, *Associate Dean of undergraduate programs, Hawthorn College of Business, WMU*

Roger Tang, *Professor, Department of Accountancy, WMU*

Ying Zeng, *Senior Coordinator on Asia, Haenicke Institute for Global Education, WMU*

Mingming Feng, *Assistant Professor, Department of Accountancy, WMU*

5:30 p.m.

Adjourn

6:00 p.m.

Dinner



Hunan Gardens on W. Main