

SHEET LIST

- 1 TITLE SHEET
- 2 PLAN / PROFILE 0+00 TO 4+50
- 3 PLAN / PROFILE 4+50 TO 8+50
- 4 PLAN / PROFILE 8+50 TO 12+00
- 5 PLAN DETAILS
- 6 SECTIONS
- 7 PLAN DETAILS
- 8 DRAKE ROAD TRAFFIC CONTROL PLAN
- 9 SOIL EROSION & SEDIMENT CONTROL (SESC) PLAN

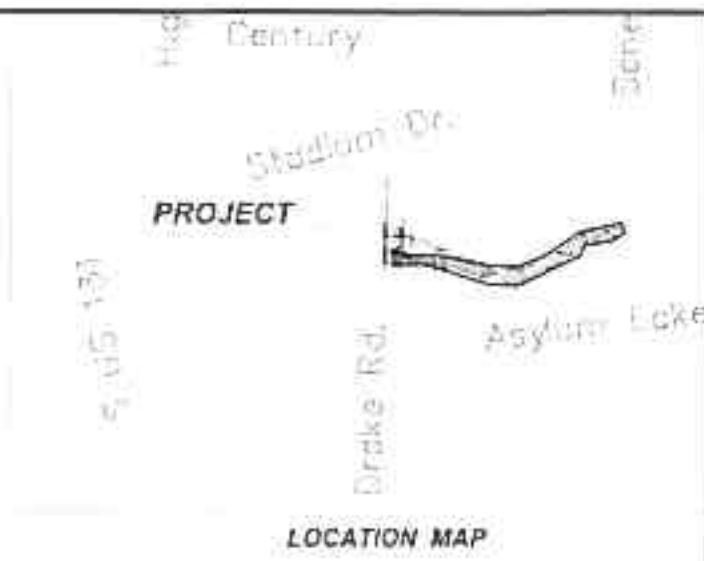

***Asylum Lake Policy and Management Council  
and  
Western Michigan University***

***ASYLUM LAKE STORM WATER  
TREATMENT PROJECT***

<b>KIESER ASSOCIATES</b> <small>INCORPORATED</small>
DATE: _____ DRAWN BY: _____ CHECKED BY: _____ SCALE: _____
ALPMC and Western Michigan University
ASYLUM LAKE STORM WATER TREATMENT PROJECT
TITLE SHEET
1

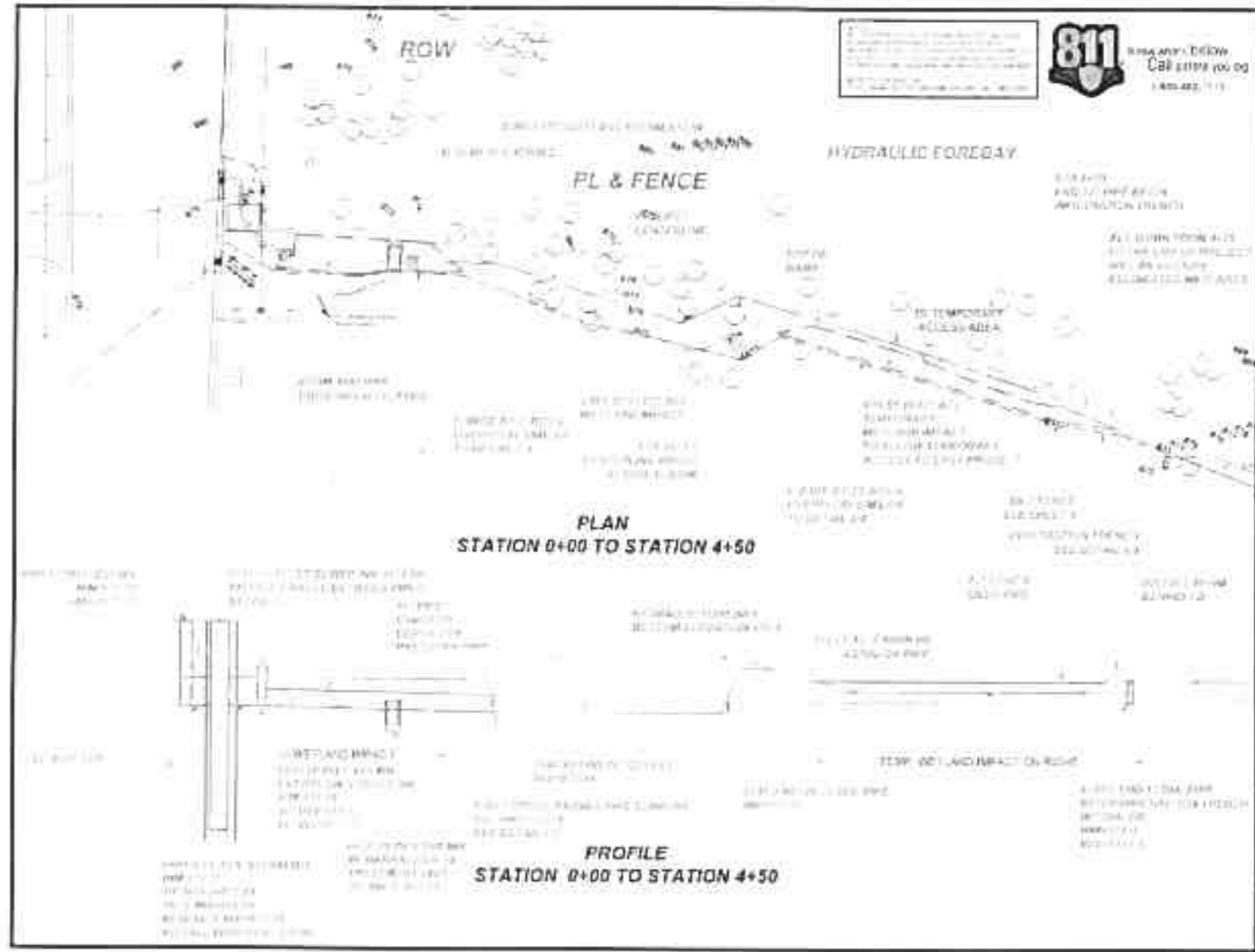

**KIESER ASSOCIATES**  
 A PROFESSIONAL ENGINEERING FIRM  
 1000 W. GRAND AVENUE, SUITE 100  
 ANN ARBOR, MI 48106-1500  
 TEL: 734.769.1234  
 FAX: 734.769.1235  
 WWW.KIESERASSOCIATES.COM

**ALPMC  
 and  
 Western  
 Michigan  
 University**

**ASYLUM LAKE  
 STORM WATER  
 TREATMENT  
 PROJECT**

**PLAN /  
 PROFILE  
 0+00 TO 4+50**

**2**

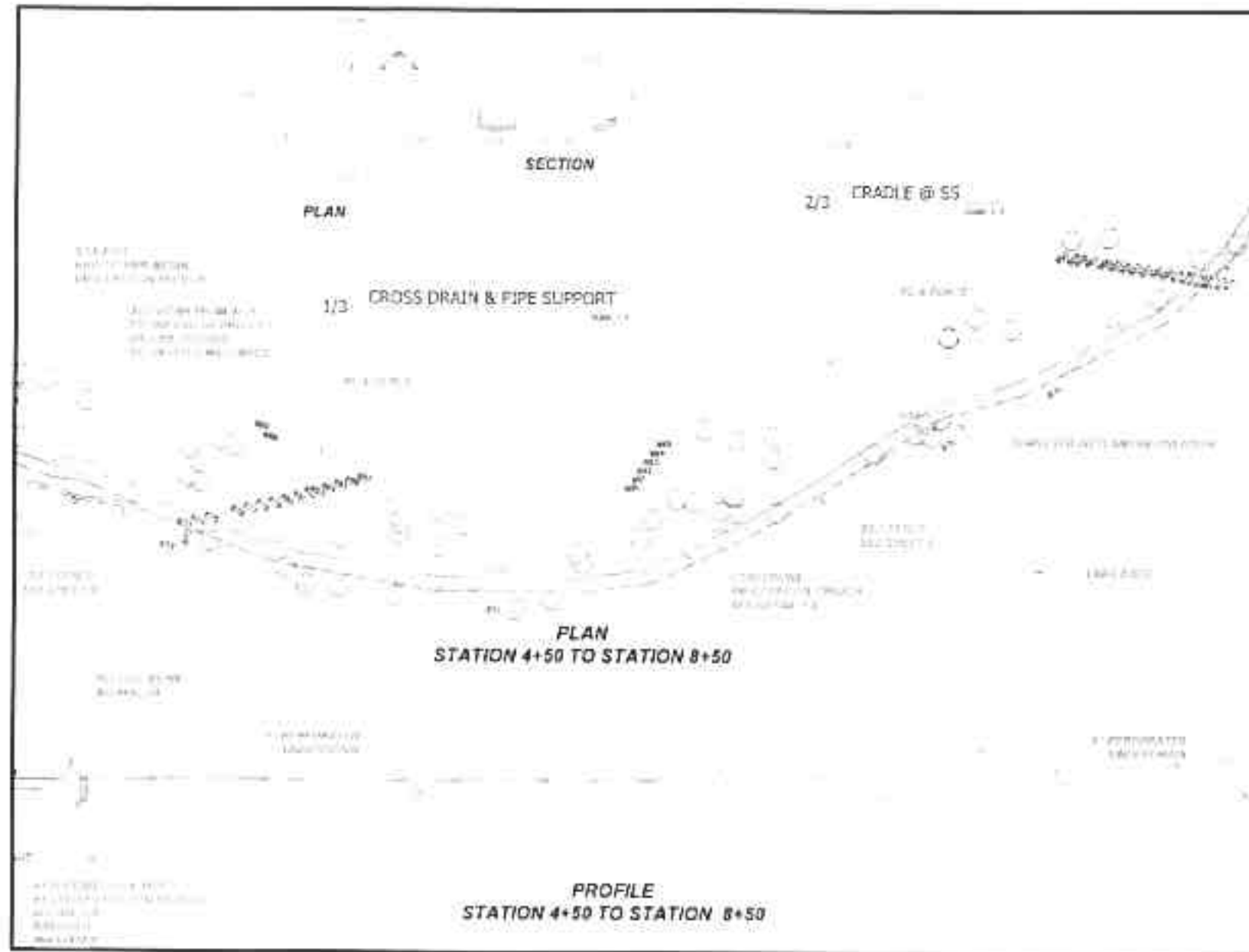

**KIESER ASSOCIATES**  
INCORPORATED  
1000 WEST WASHINGTON AVENUE  
ANN ARBOR, MICHIGAN 48106-1500  
PH: 734.769.1234  
WWW.KIESERASSOCIATES.COM

DATE:	08/11/11
PROJECT:	ASYLUM LAKE STORM WATER TREATMENT PROJECT
DRAWING NO.:	3
SCALE:	AS SHOWN
DESIGNED BY:	
CHECKED BY:	
APPROVED BY:	

ALPMC  
and  
Western  
Michigan  
University

ASYLUM LAKE  
STORM WATER  
TREATMENT  
PROJECT

PLAN /  
PROFILE  
4+50 TO 8+50

3

1/4 TRENCH SECTION  
Scale: 1:2

PLAN  
STATION 8+50 TO STATION 12+00

PROFILE  
STATION 8+50 TO STATION 12+00

2/4 OUTFALL DETAIL  
Scale: 1:2

**KIESER ASSOCIATES**  
INCORPORATED  
1000 WEST WASHINGTON AVENUE  
ANN ARBOR, MICHIGAN 48106  
TEL: 734.769.1234  
WWW.KIESERASSOCIATES.COM

DATE:	
PROJECT:	

ALPMC  
and  
Western  
Michigan  
University  
  
ASYLUM LAKE  
STORM WATER  
TREATMENT  
PROJECT

PLAN /  
PROFILE  
8+50 TO 12+00

4

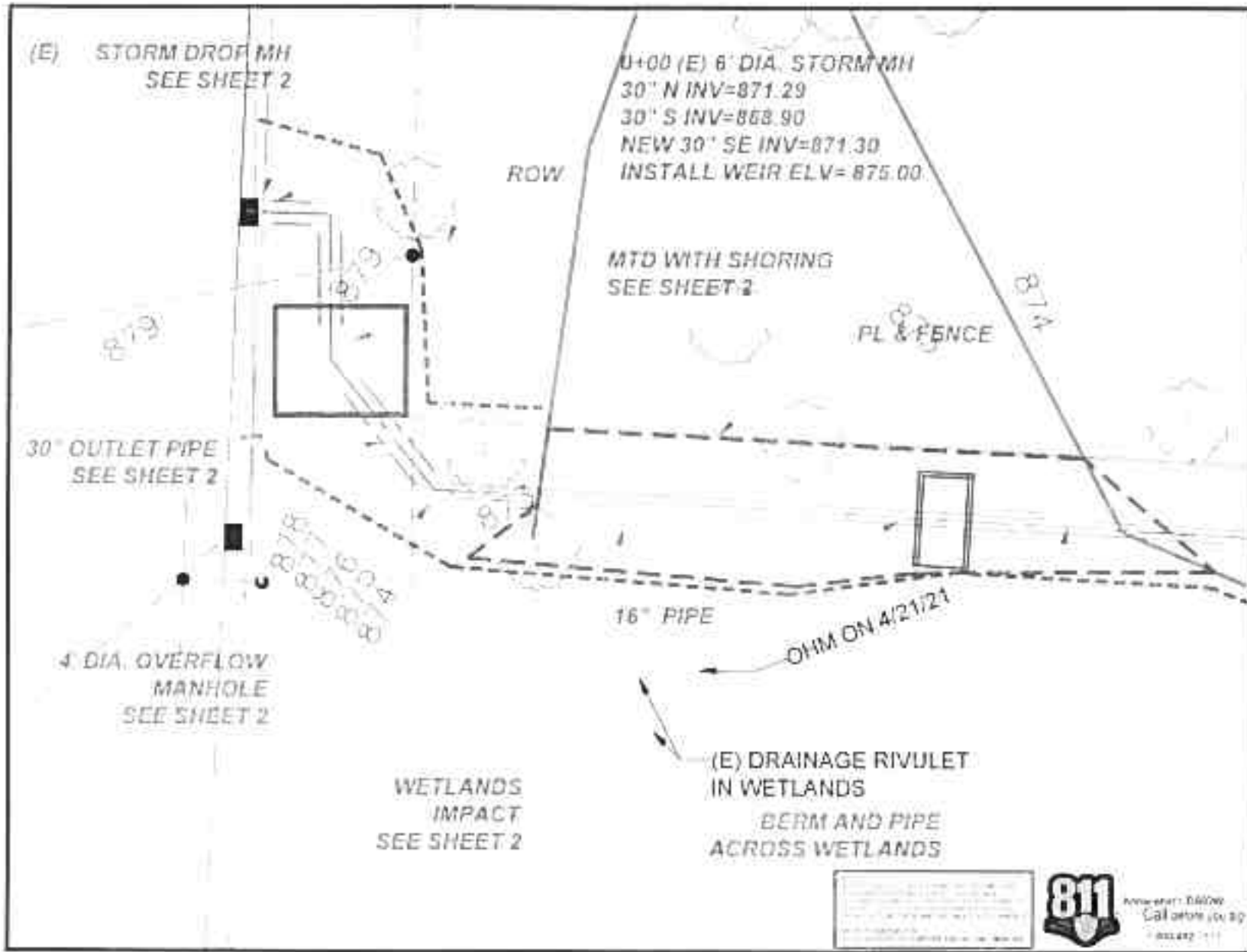

**KIESER ASSOCIATES**  
INCORPORATED  
1000 W. WASHINGTON ST.  
ANN ARBOR, MI 48106  
734.769.1111

DATE	DESCRIPTION

ALPMC  
and  
Western  
Michigan  
University

ASYLUM LAKE  
STORM WATER  
TREATMENT  
PROJECT

**PLAN  
DETAILS**

**5**

**811** Michigan 811  
Call before you dig  
www.michigan811.com

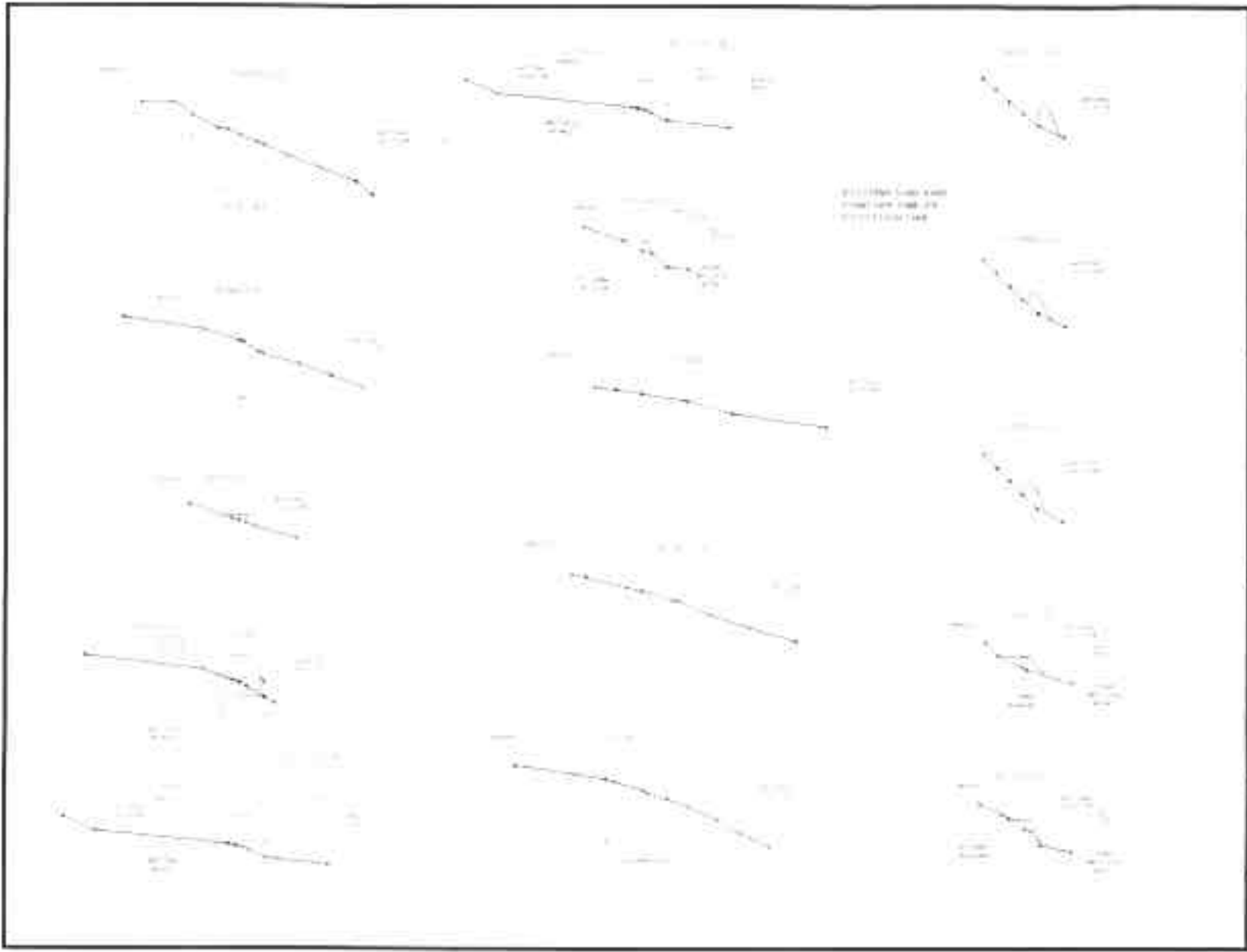

**KIESER & ASSOCIATES**  
 CONSULTING ENGINEERS AND ARCHITECTS  
 1000 WEST WASHINGTON AVENUE  
 ANN ARBOR, MICHIGAN 48106  
 TEL: 734/769-1000  
 FAX: 734/769-1001  
 WWW.KESER.COM

DATE: 11/11/11  
 DRAWN BY: J. HARRIS  
 CHECKED BY: J. HARRIS  
 APPROVED BY: J. HARRIS

ALPMC  
 and  
 Western  
 Michigan  
 University  
 ASYLUM LAKE  
 STORM WATER  
 TREATMENT  
 PROJECT

**SECTIONS**

SECTION  
**6**

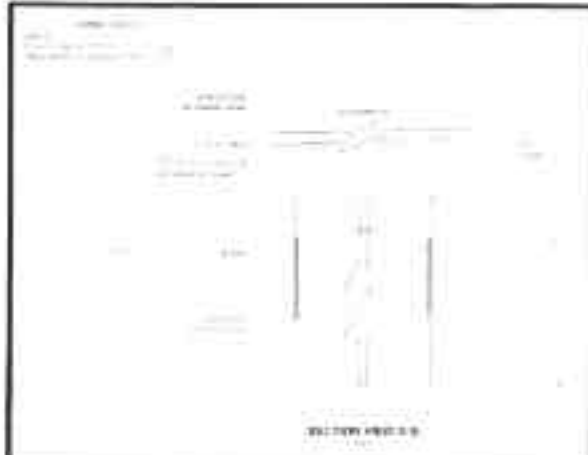

ELEVATION

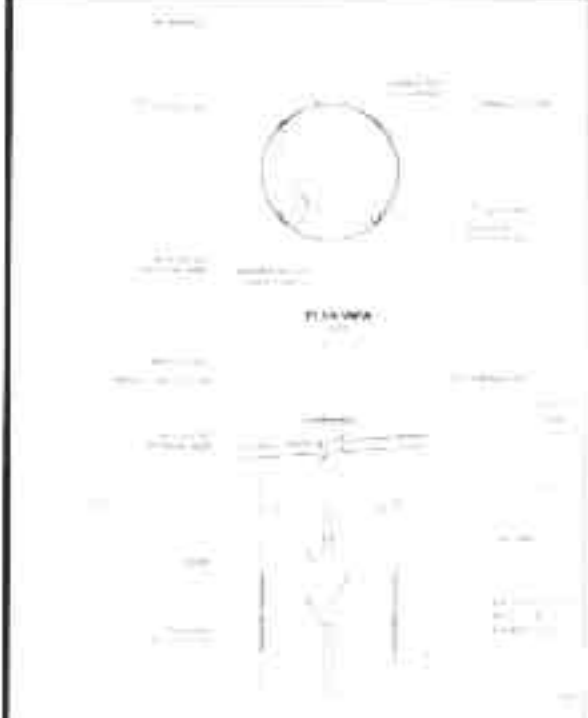

PLAN



CROSS SECTION

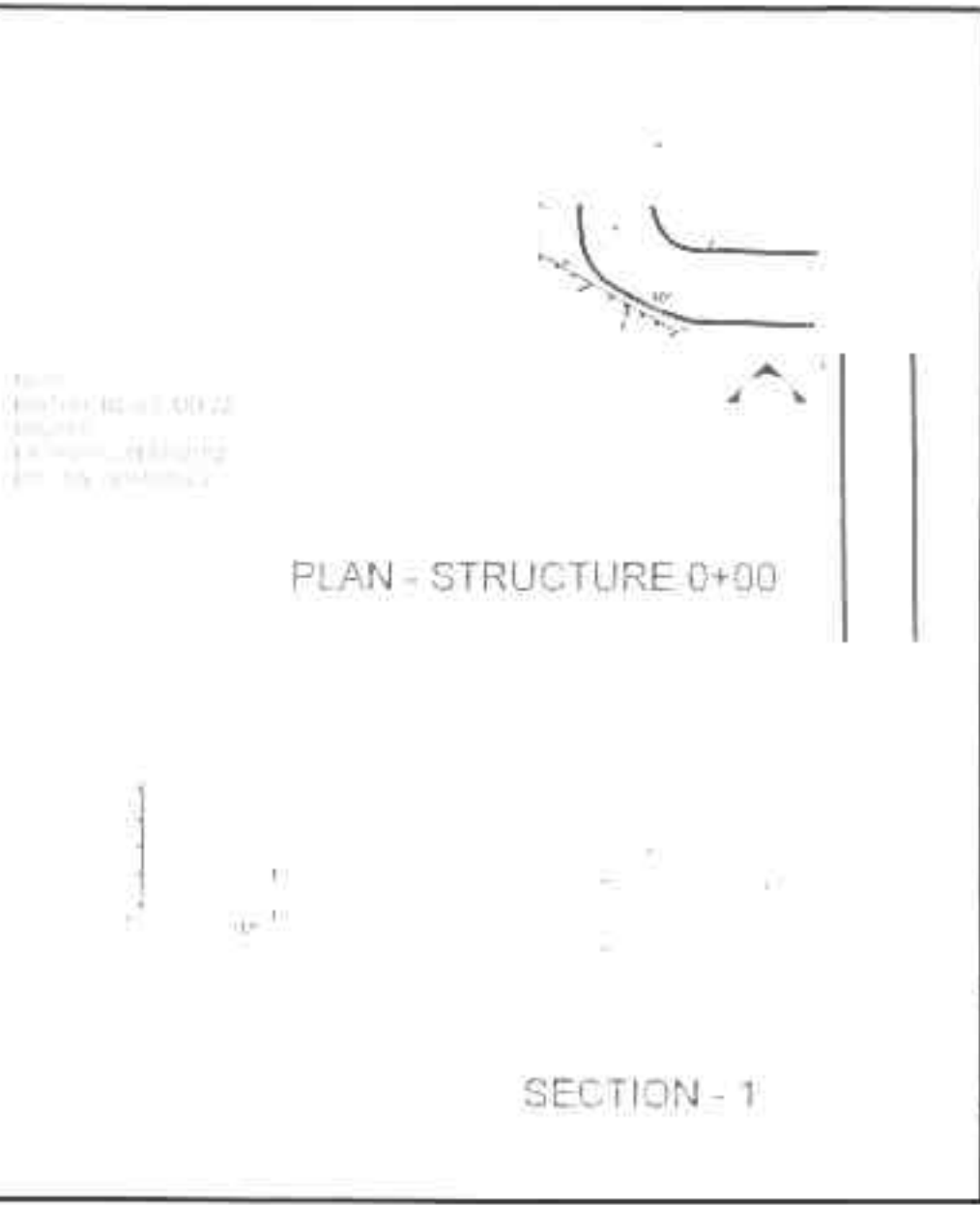

PLAN - STRUCTURE 0+00

SECTION - 1

DATE: 10/10/2012  
 DRAWN BY: [Name]  
 CHECKED BY: [Name]



NO.	DESCRIPTION

ALPMC  
 and  
 Western  
 Michigan  
 University  
 ASYLUM LAKE  
 STORM WATER  
 TREATMENT  
 PROJECT

DETAILS  
 SHT. 1

7

## WORK ZONE TRAFFIC CONTROL PLAN

TRAFFIC CONTROL TO BE BASED ON MICHIGAN MANUAL ON UNIFORM TRAFFIC CONTROL DEVICES (MUTCD) LATEST EDITION.

- SHIFT NORTH BOUND TRAFFIC LANES 7 FEET AROUND WORK ZONE PER MUTCD REQUIREMENTS AND SIGNAGE.
- SOUTH BOUND TRAFFIC TO BE UNRESTRICTED EXCEPT FOR CAUTION SIGNAGE AS PER MUTCD.
- BIKE LANE TO BE DISCONTINUED THROUGH TEMPORARY WORK ZONE. SIGNAGE TO REFLECT CONFIGURATION.
- INSTALL ADVANCE WARNING SIGNS AS IDENTIFIED IN THE MUTCD FOR THE SPEED ZONE ON DRAKE RD.
- INSTALL ADVANCE WARNING SIGNS ON DRAKE ROAD PRIOR TO PROJECT STAGING AREA PER MUTCD FOR CONSTRUCTION TRAFFIC.

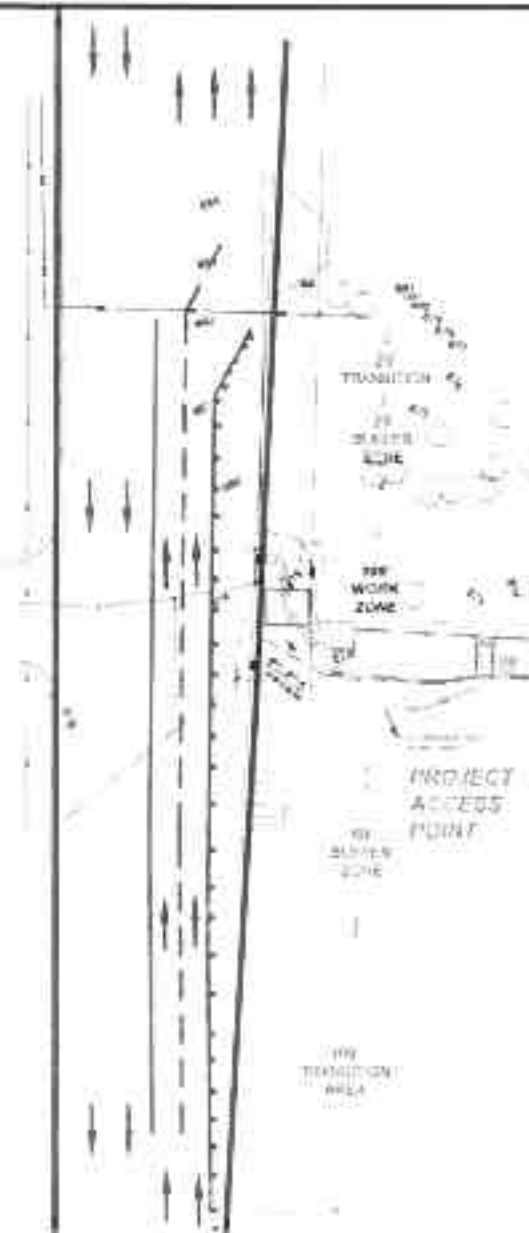
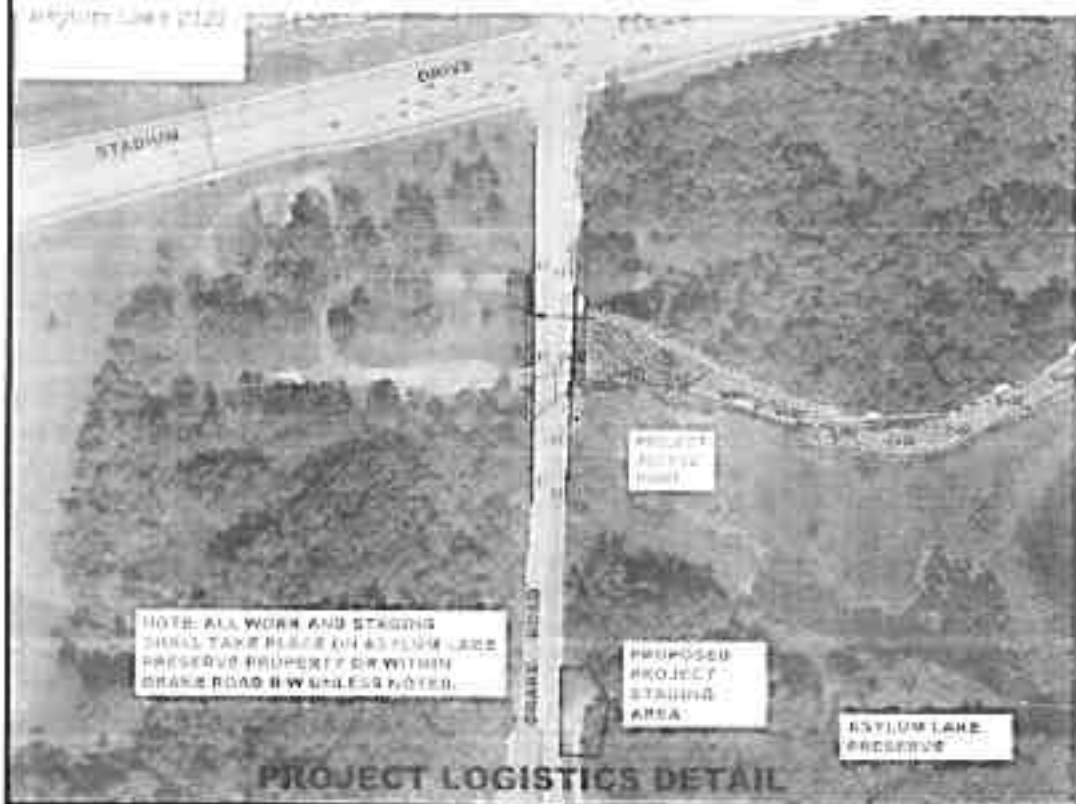

**KIESER ASSOCIATES**  
CONSULTING ENGINEERS AND ARCHITECTS

DATE:	
SCALE:	
PROJECT NO.:	
DRAWN BY:	
CHECKED BY:	

ALPMC  
 and  
 Western  
 Michigan  
 University  
 ASYLUM LAKE  
 STORM WATER  
 TREATMENT  
 PROJECT

TRAFFIC  
 CONTROL  
 PLAN

8





**SOIL EROSION CONTROL GEOTEXTILE SILT FENCE**

1. CONSTRUCTION SHALL BE COMPLETED WITHIN THE SPECIFIED PERIODS OF TIME.

2. ALL EROSION CONTROL MEASURES SHALL BE INSTALLED PRIOR TO THE START OF CONSTRUCTION.

3. THE CONTRACTOR SHALL MAINTAIN ALL EROSION CONTROL MEASURES THROUGHOUT THE CONSTRUCTION PERIOD.

4. THE CONTRACTOR SHALL REMOVE AND DESTROY ALL EROSION CONTROL MEASURES UPON COMPLETION OF THE PROJECT.

5. THE CONTRACTOR SHALL BE RESPONSIBLE FOR OBTAINING ALL NECESSARY PERMITS AND APPROVALS FROM THE APPLICABLE AGENCIES.

6. THE CONTRACTOR SHALL MAINTAIN ACCESS TO ALL ADJACENT PROPERTIES AT ALL TIMES.

7. THE CONTRACTOR SHALL MAINTAIN ALL EXISTING UTILITIES AND STRUCTURES.

8. THE CONTRACTOR SHALL MAINTAIN ADEQUATE RECORDS OF ALL EROSION CONTROL MEASURES.

9. THE CONTRACTOR SHALL BE RESPONSIBLE FOR THE PROTECTION OF ALL ADJACENT PROPERTIES AND RESOURCES.

10. THE CONTRACTOR SHALL MAINTAIN ADEQUATE RECORDS OF ALL EROSION CONTROL MEASURES.

**SOIL EROSION CONTROL  
GEOTEXTILE SILT FENCE**

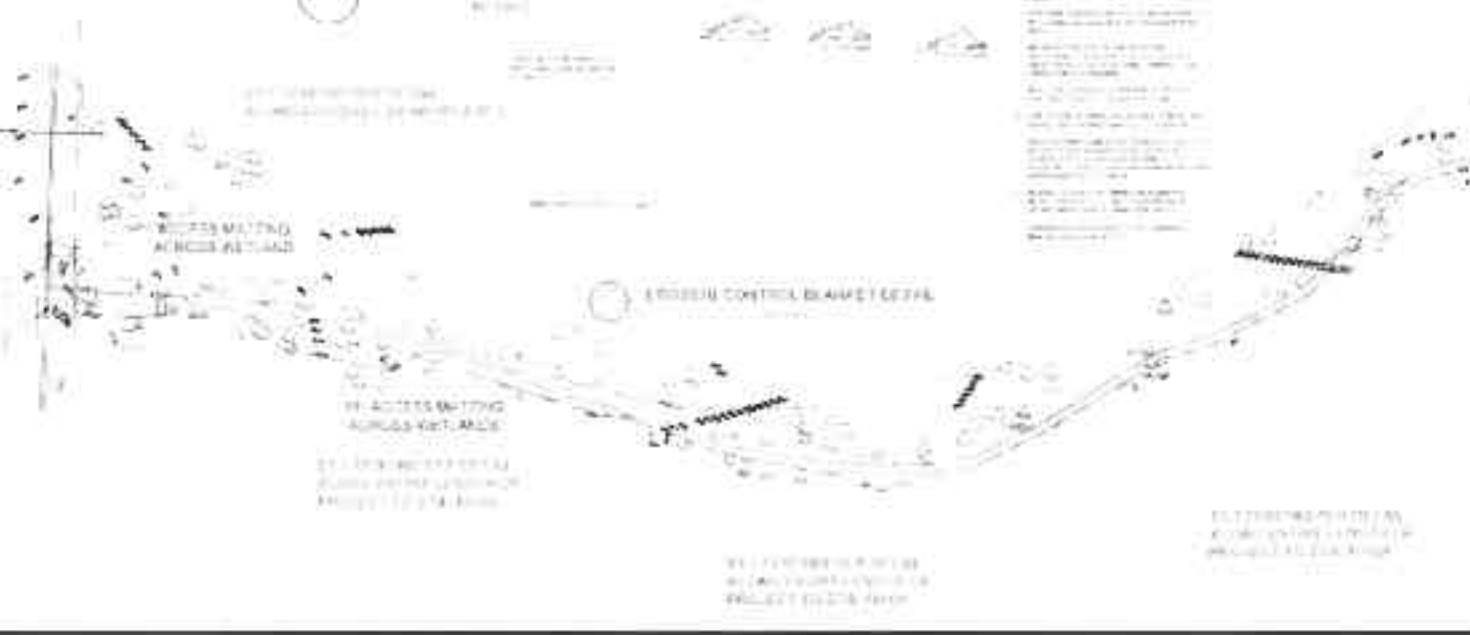

**KIESER ASSOCIATES**  
LANDSCAPE ARCHITECTS

NO. 001	REVISION

ALPMC and Western Michigan University  
ASYLUM LAKE STORM WATER TREATMENT PROJECT

**SESC PLAN**

9